

# 3D Plants:

Students build  
AVR plant  
models to  
understand the  
role of design  
in STEM

September 2023



DONALD DANFORTH  
PLANT SCIENCE CENTER





# Maize (*Zea mays*) male floret

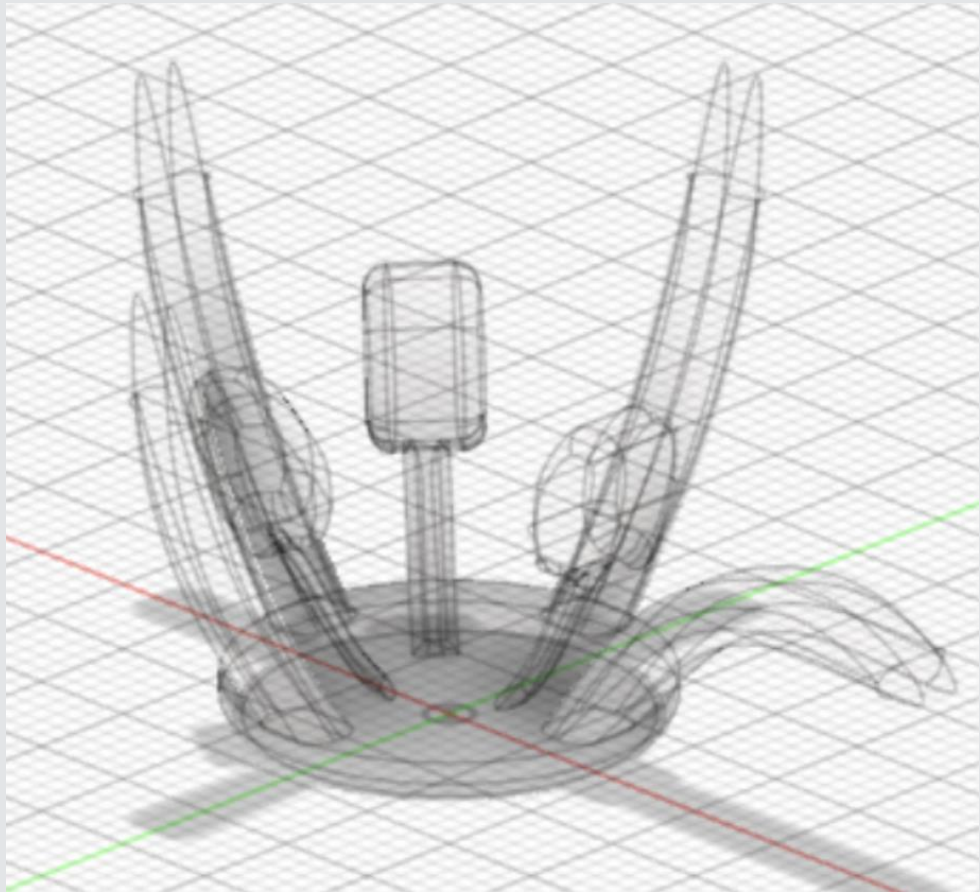

**Maize**  
**(*Zea mays*)**  
**male floret**

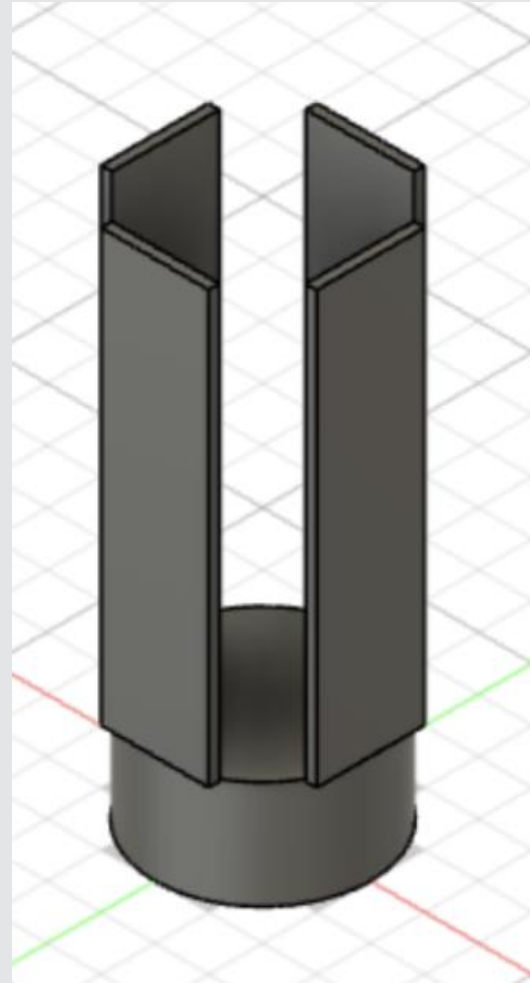

# Maize (*Zea mays*) male floret

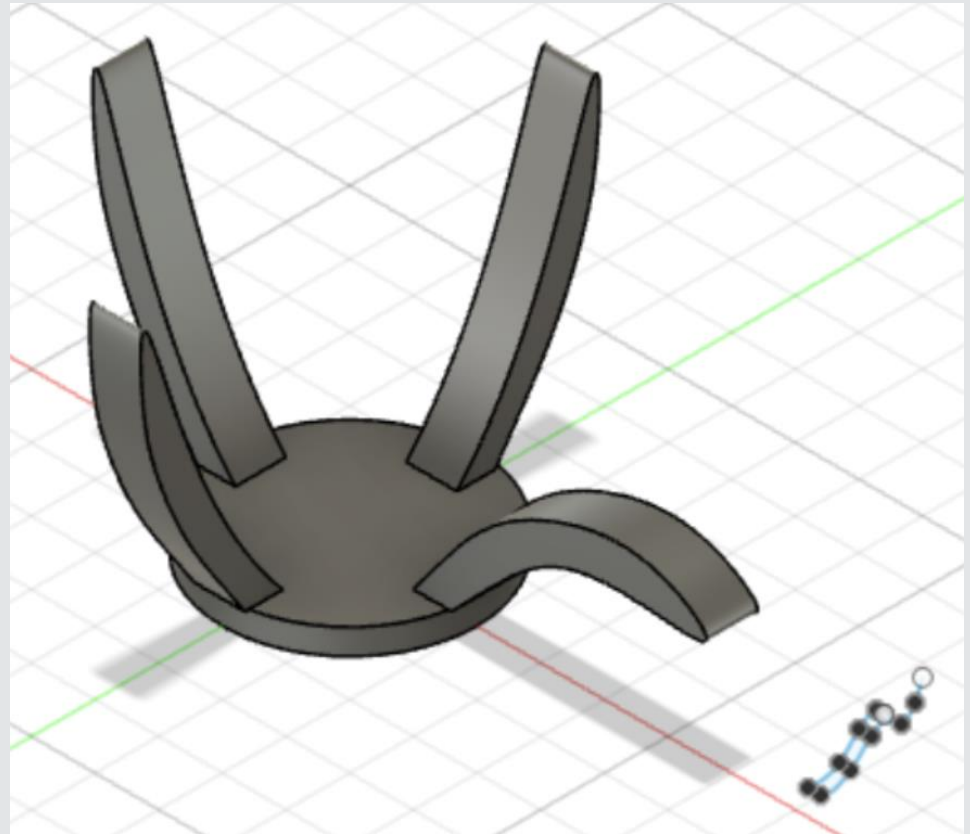

**Maize**  
**(*Zea mays*)**  
**male floret**

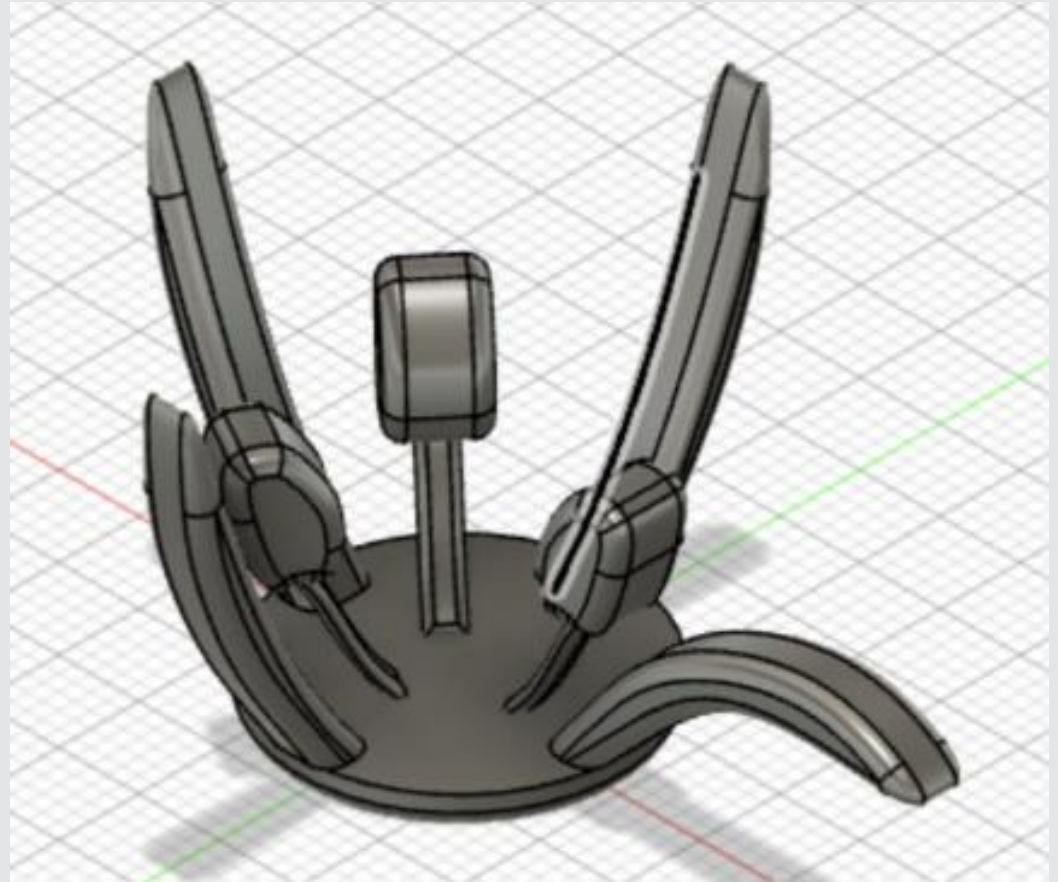

**Maize**  
**(*Zea mays*)**  
**male floret**

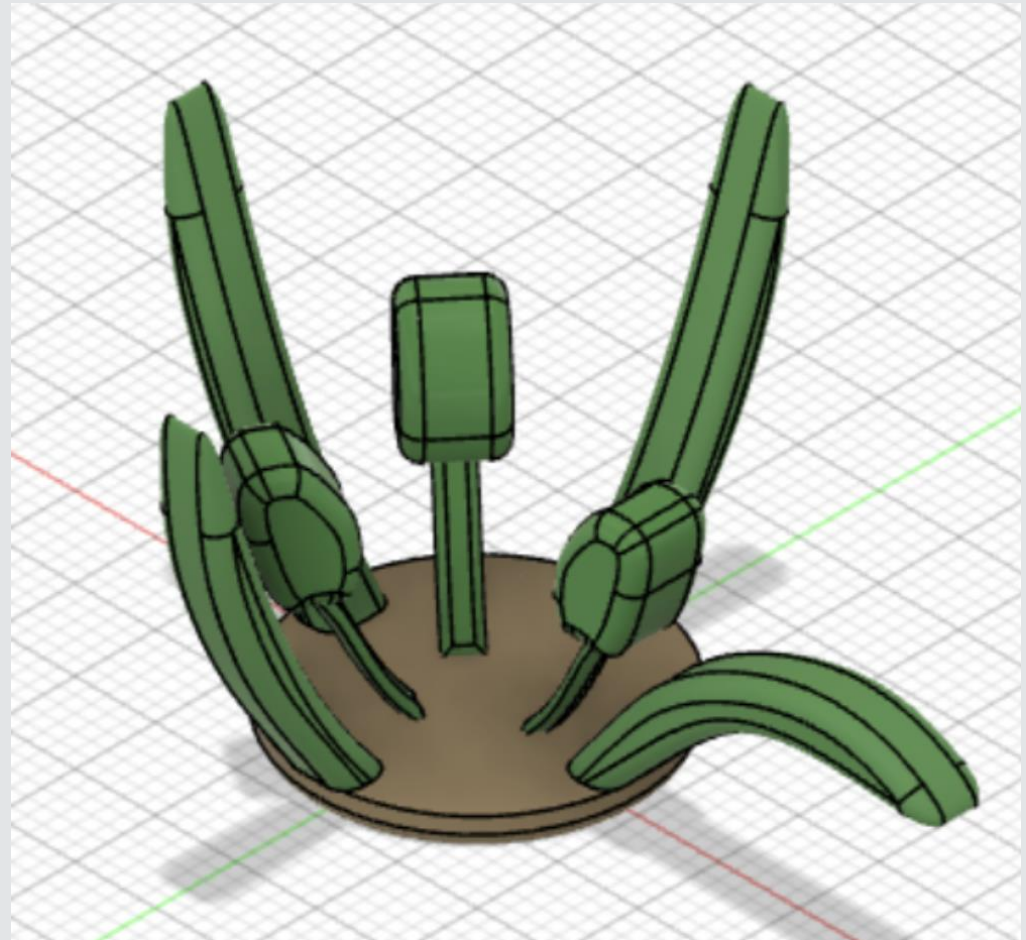

# Maize (*Zea mays*) kernel

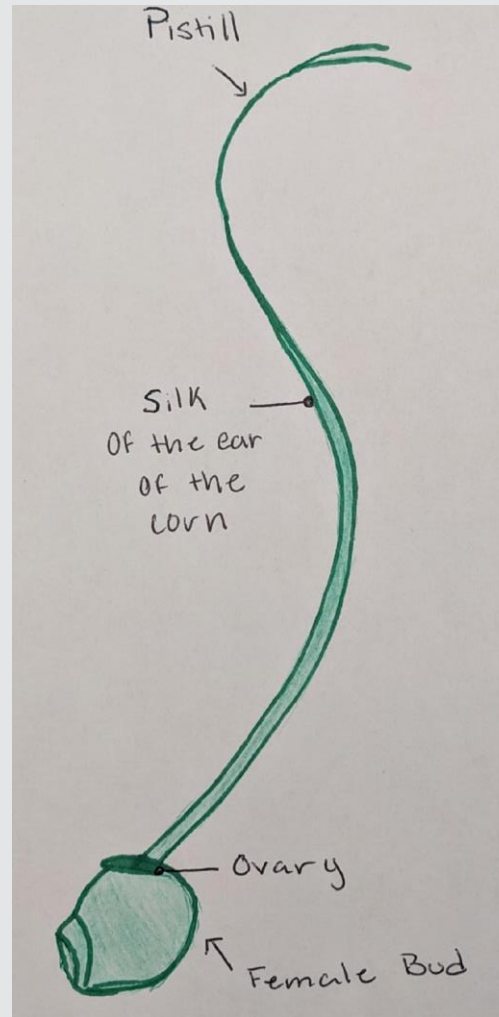



# Maize (*Zea mays*) kernel

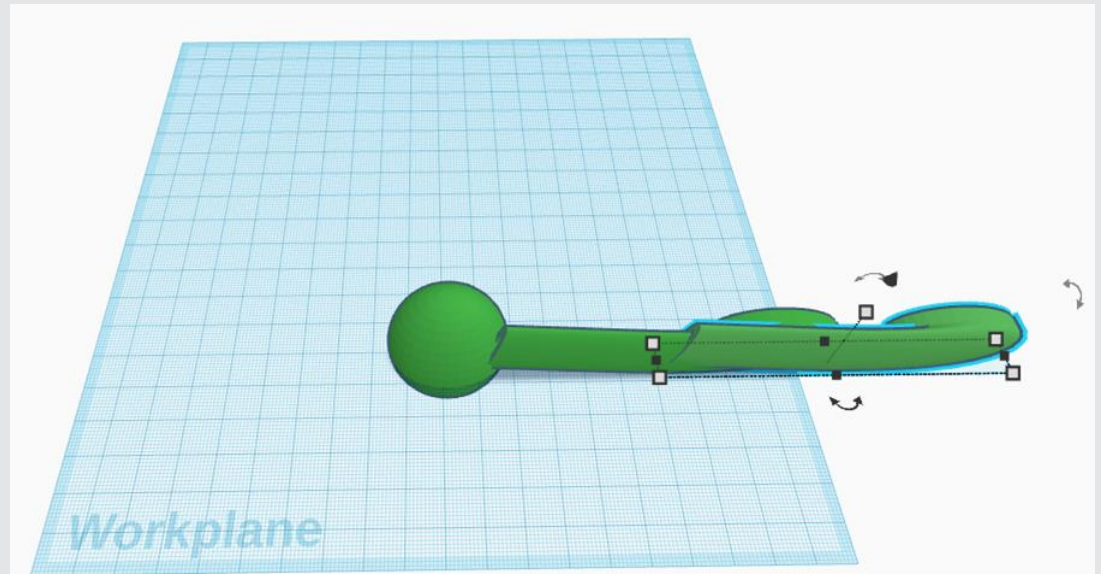

**Maize**  
**(*Zea mays*)**  
**female floret/pollination tube**



**Maize**  
**(*Zea mays*)**  
**female floret/pollination tube**



**Maize**  
**(*Zea mays*)**  
**female floret/pollination tube**

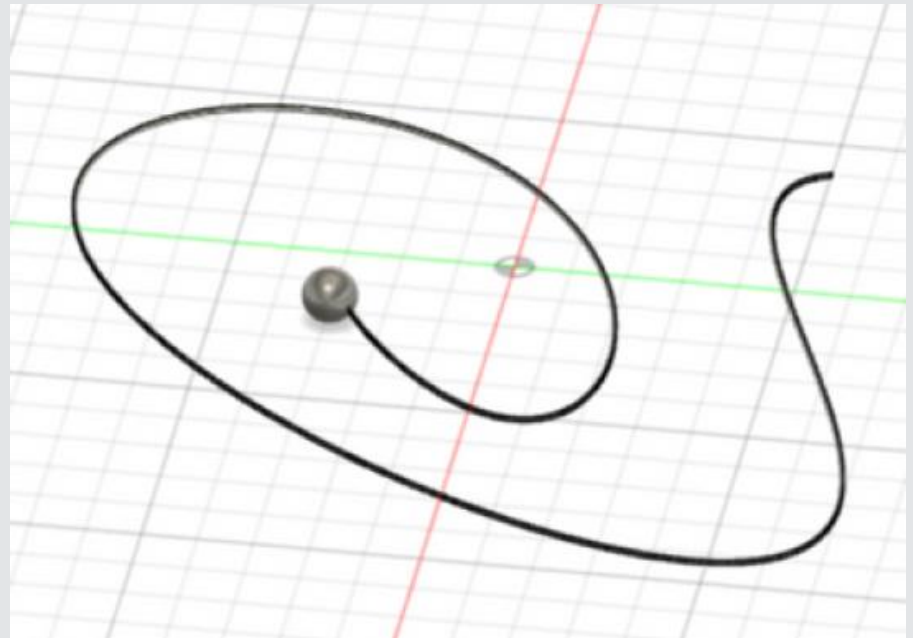

**Maize**  
**(*Zea mays*)**  
**female floret/pollination tube**

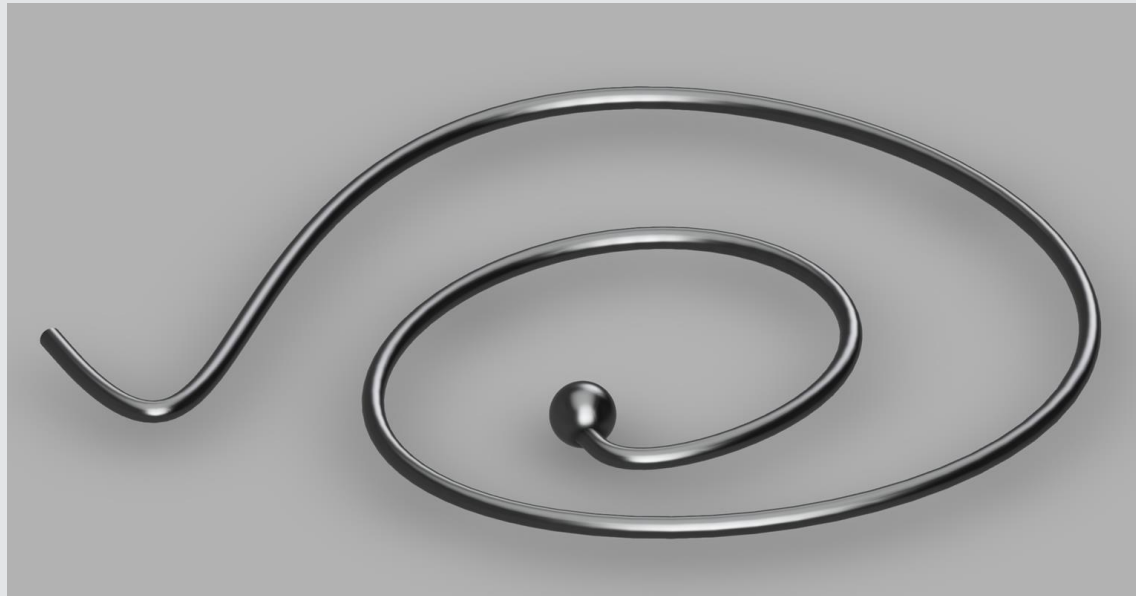

**Cassava**  
**(*Manihot esculenta*)**  
**female flower**

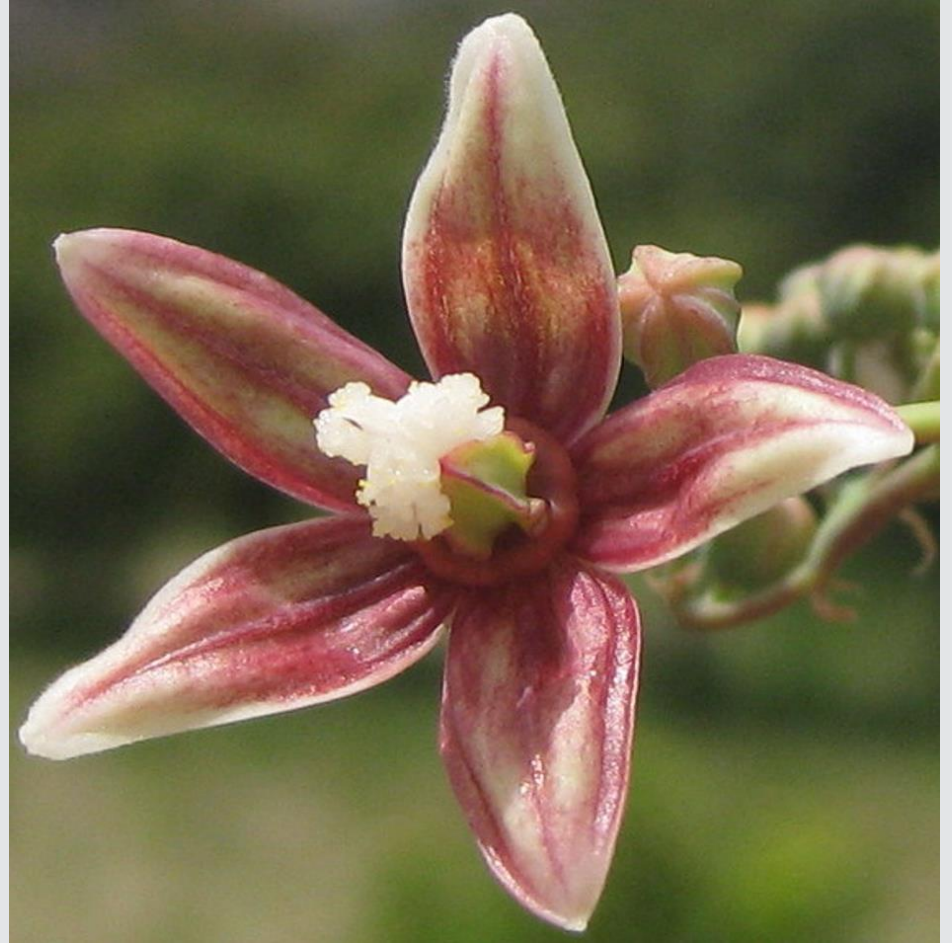

**Cassava**  
**(*Manihot esculenta*)**  
**female flower**

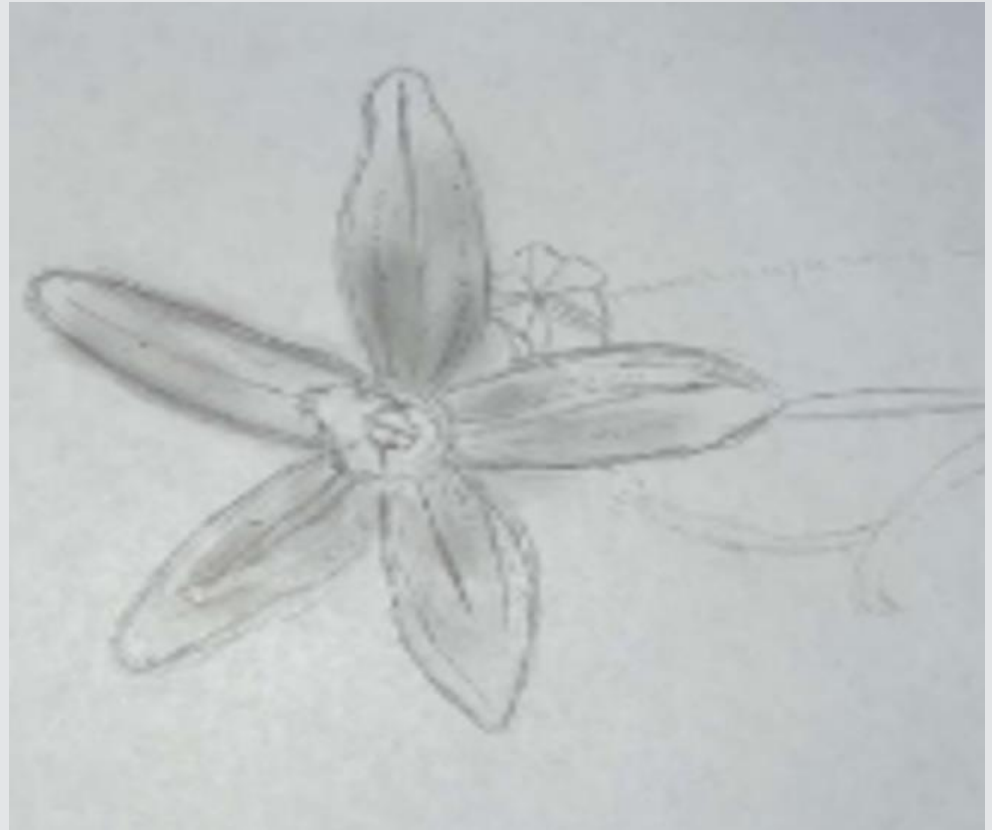

**Cassava**  
**(*Manihot esculenta*)**  
**female flower**

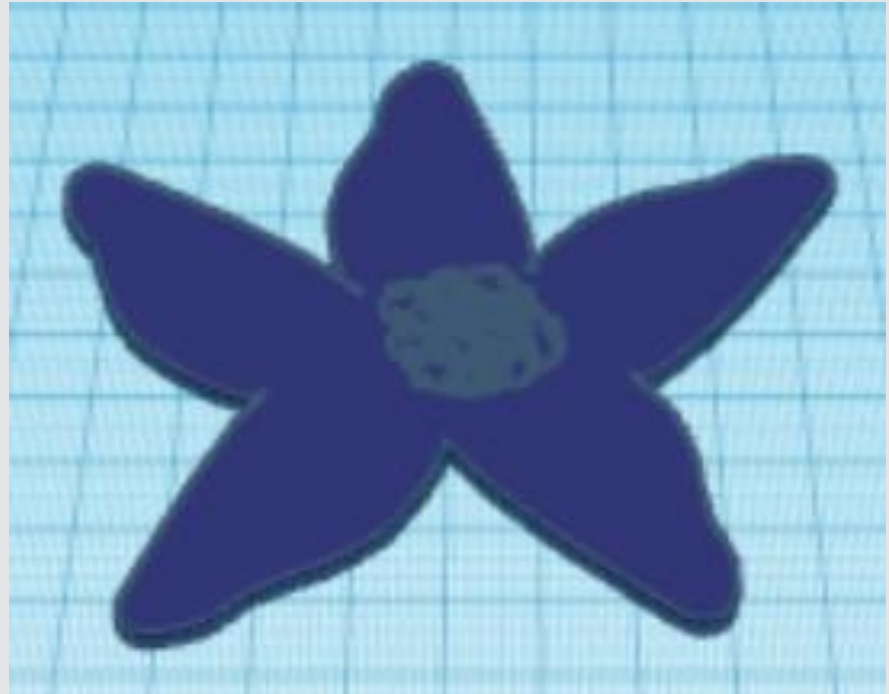



**Cassava**  
**(*Manihot esculenta*)**  
**female flower**

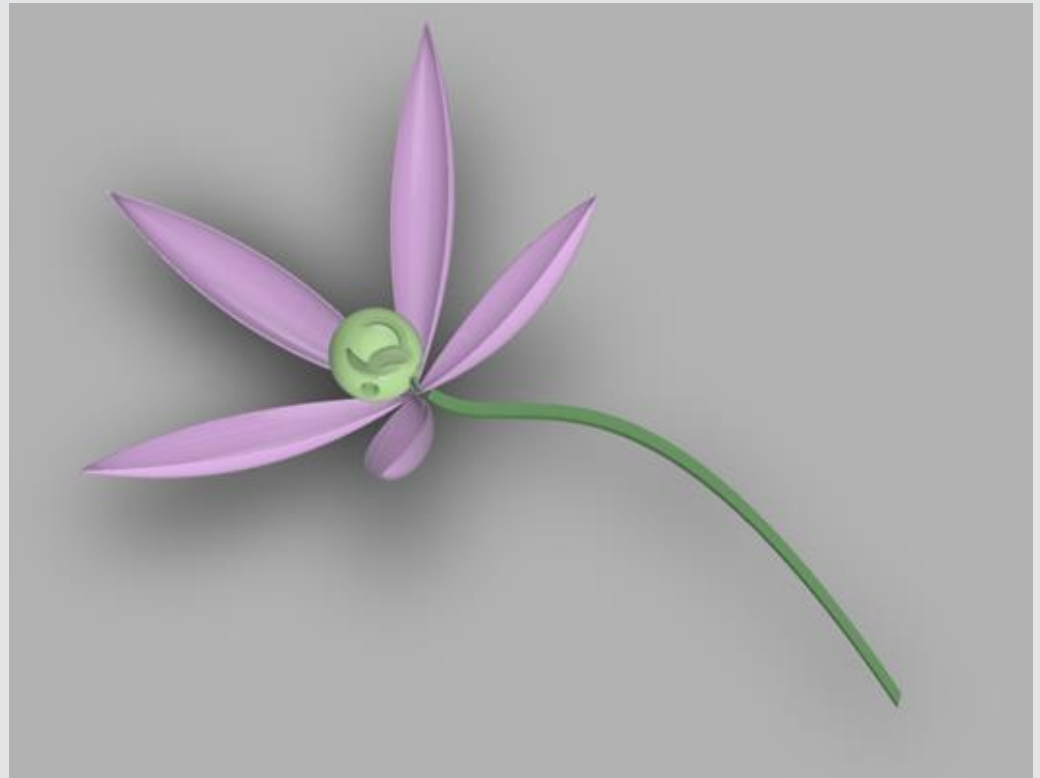

**Cassava**  
**(*Manihot esculenta*)**  
**male flower**



**Big bluestem  
(*Andropogon gerardii*)  
inflorescence**



# Big bluestem (*Andropogon gerardii*) inflorescence



**Big bluestem  
(*Andropogon gerardii*)  
inflorescence**

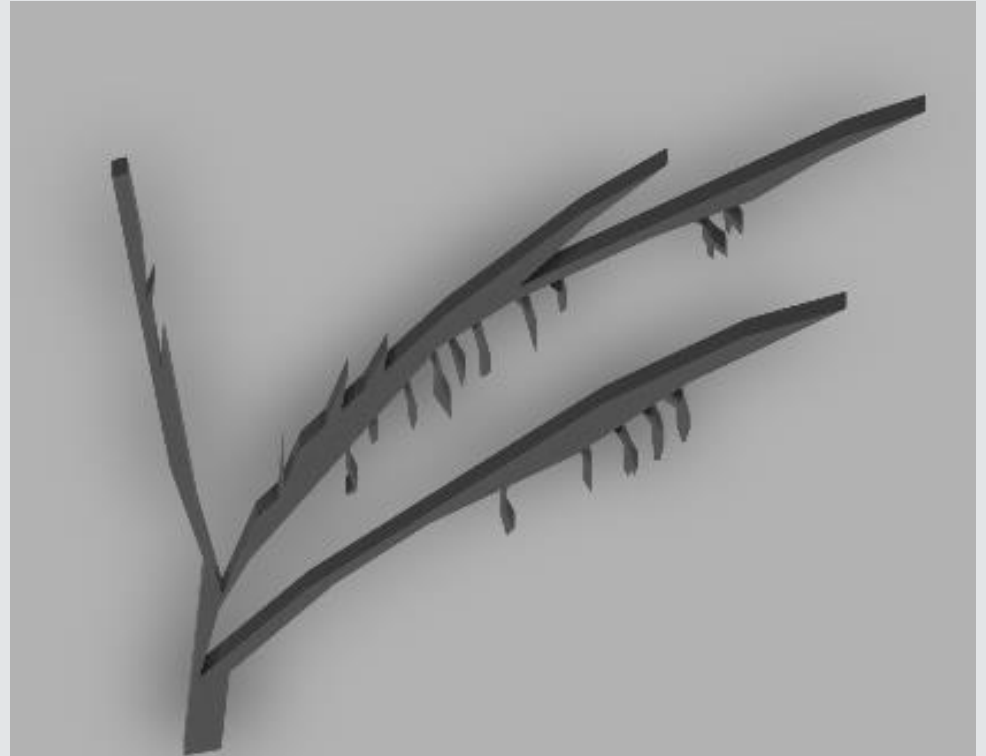

**Big bluestem  
(*Andropogon gerardii*)  
spiklet**



© 2014 Katy Chayka



DONALD DANFORTH  
PLANT SCIENCE CENTER

zSpace



**Big bluestem  
(*Andropogon gerardii*)  
spiklet**



**Big bluestem  
(*Andropogon gerardii*)  
spiklet**

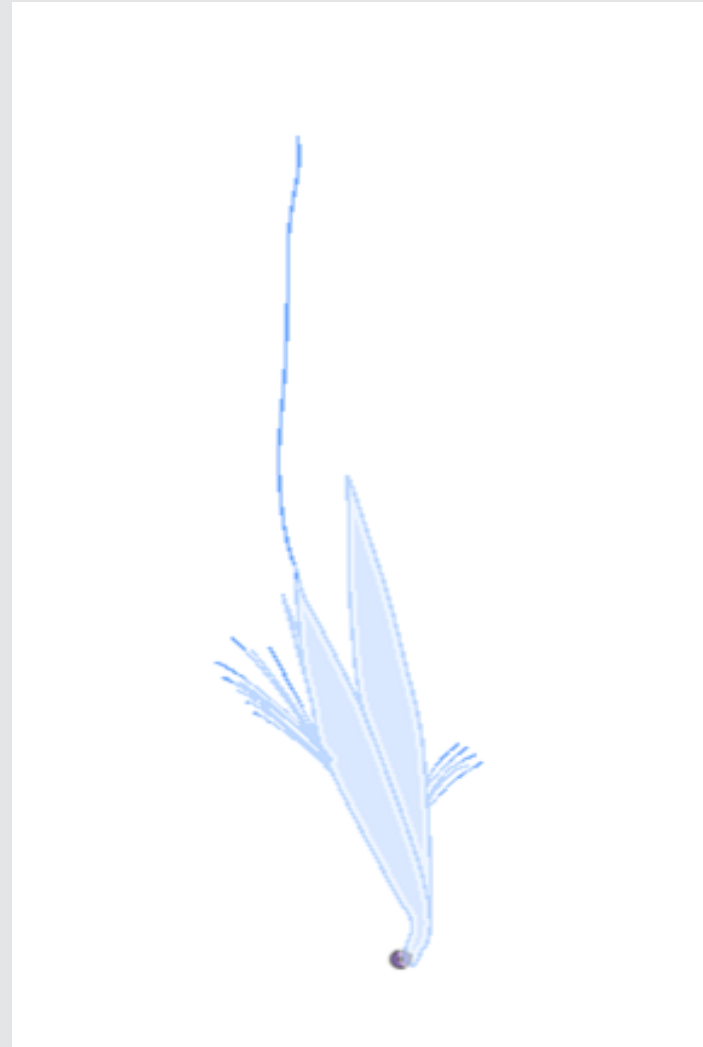



# Big bluestem (*Andropogon gerardii*) spiklet

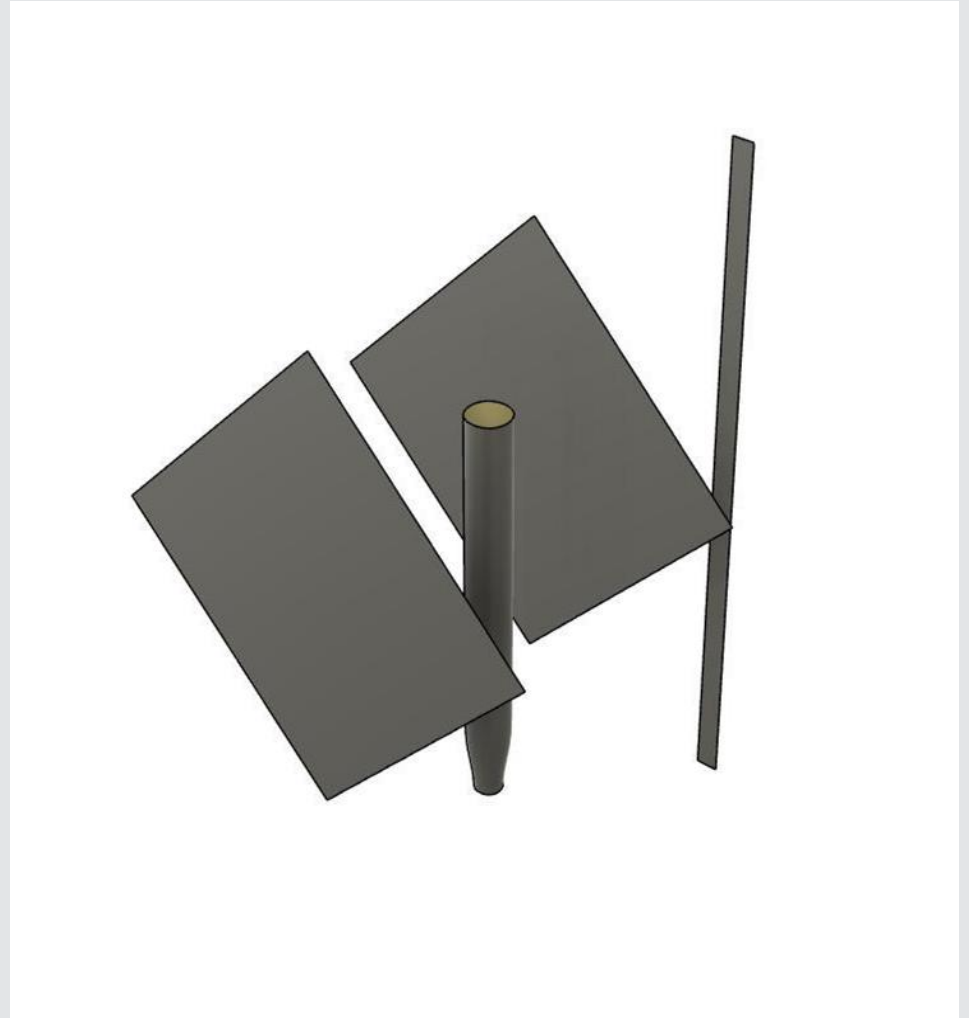

**Big bluestem  
(*Andropogon gerardii*)  
spiklet**

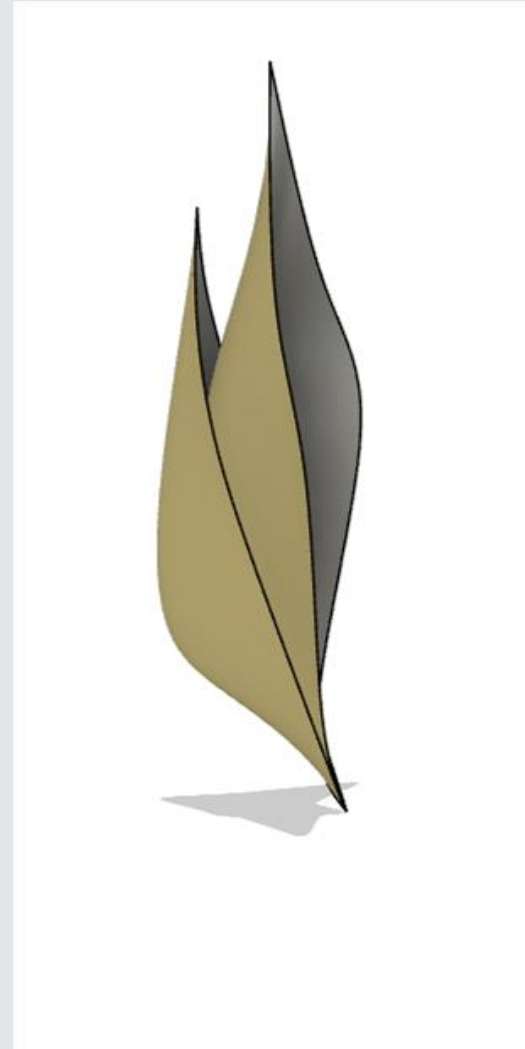

**Big bluestem  
(*Andropogon gerardii*)  
spiklet**

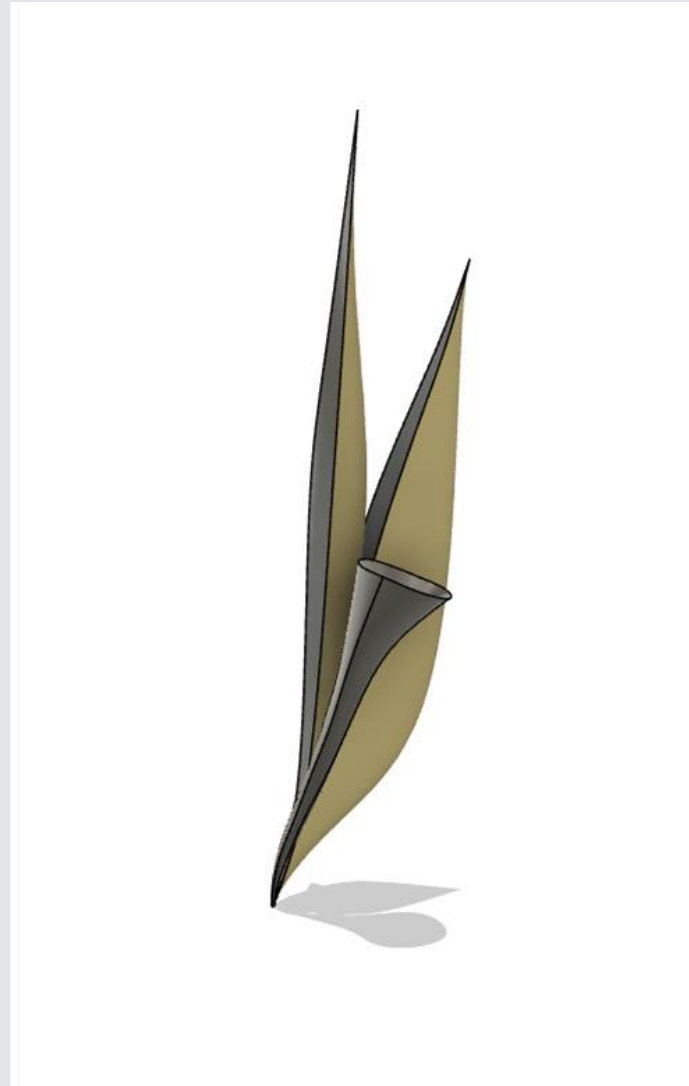

**Big bluestem  
(*Andropogon gerardii*)  
spiklet**

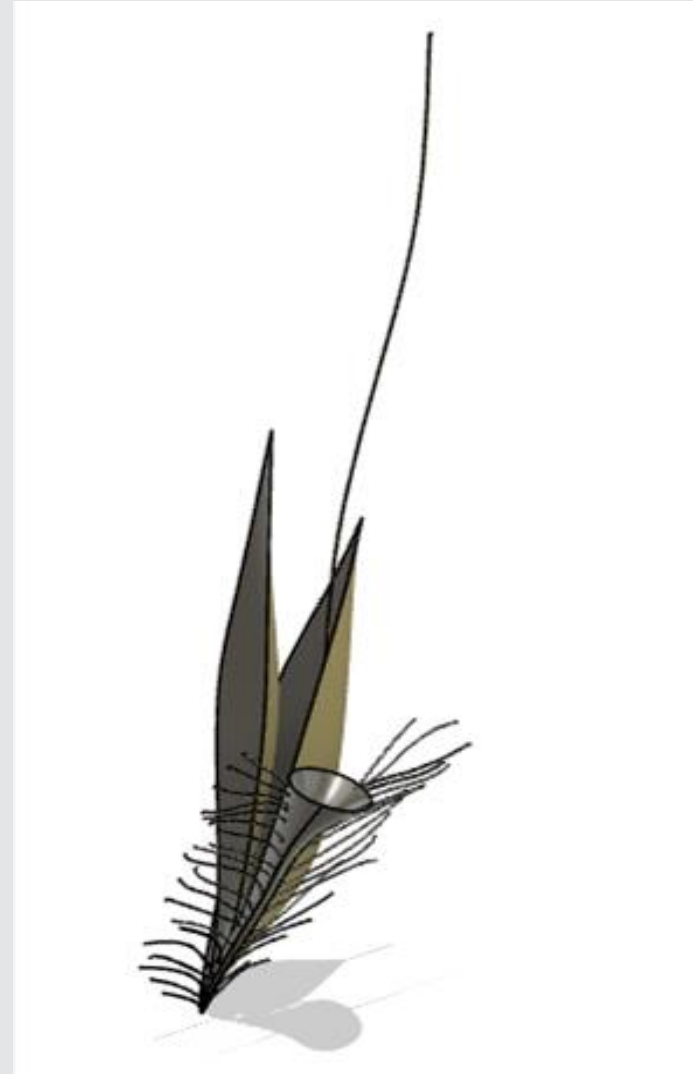

**Big bluestem  
(*Andropogon gerardii*)  
spiklet**



# Seashore paspalum (*Paspalum vaginatum*) stolon



**Seashore paspalum  
(*Paspalum vaginatum*)  
stolon**



**Seashore paspalum  
(*Paspalum vaginatum*)  
stolon**

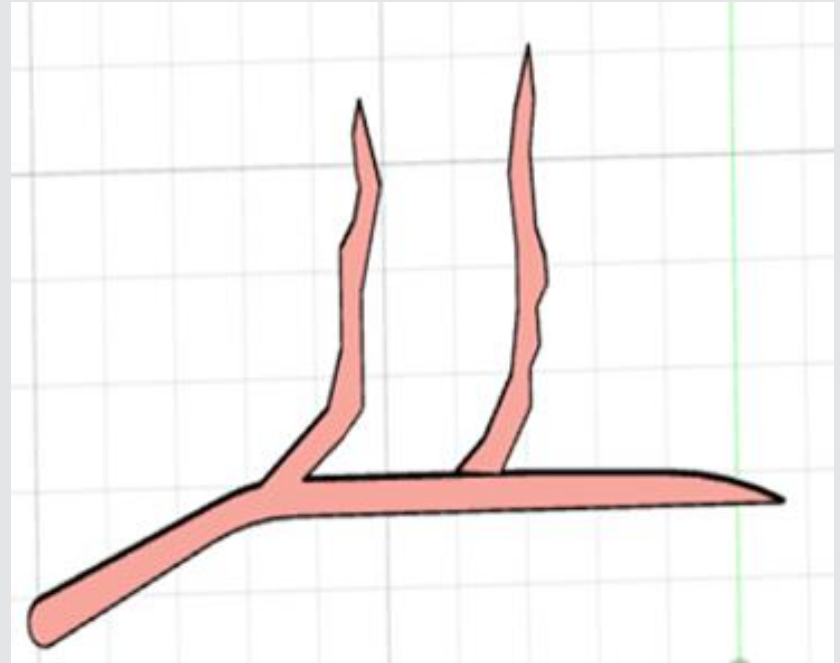



**Seashore paspalum  
(*Paspalum vaginatum*)  
stolon**

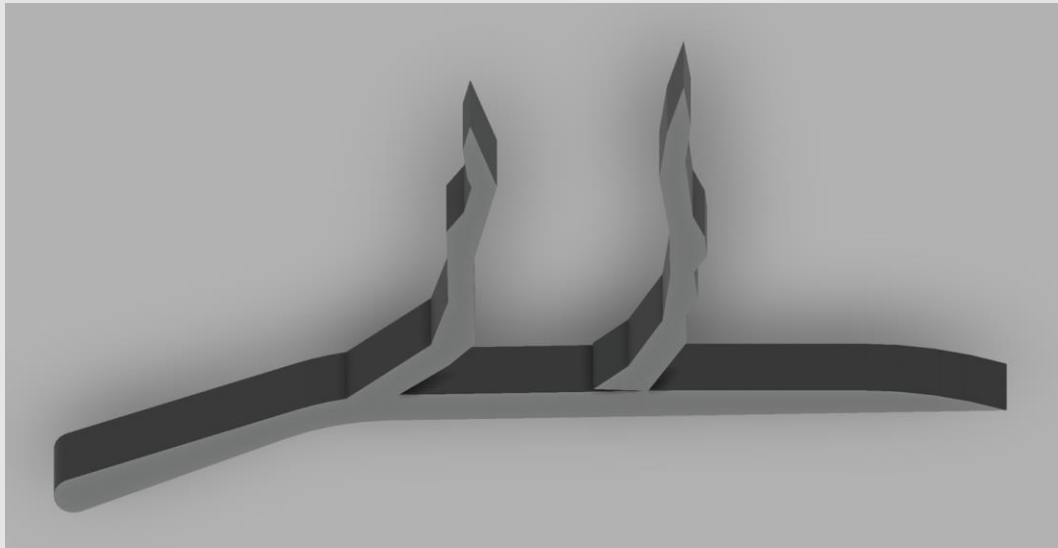

# Seashore paspalum (*Paspalum vaginatum*) stolon

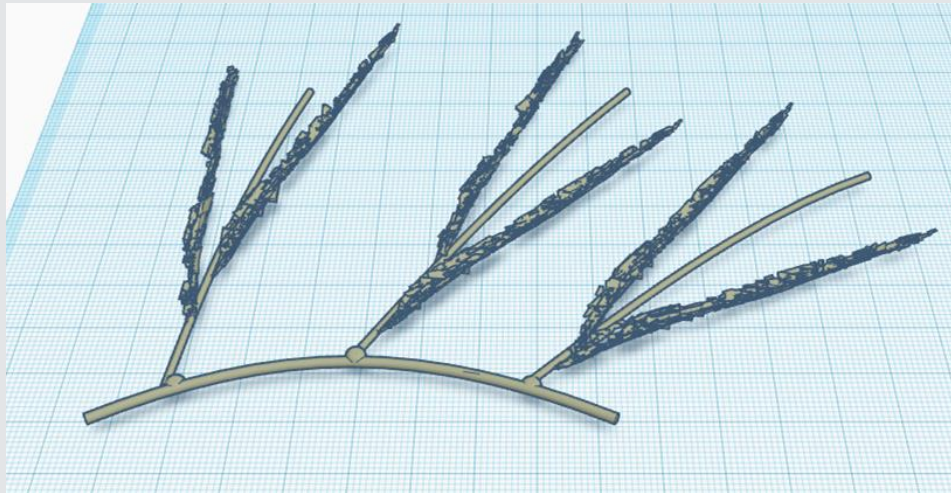

**Barrel medic**  
*(Medicago truncatula)*

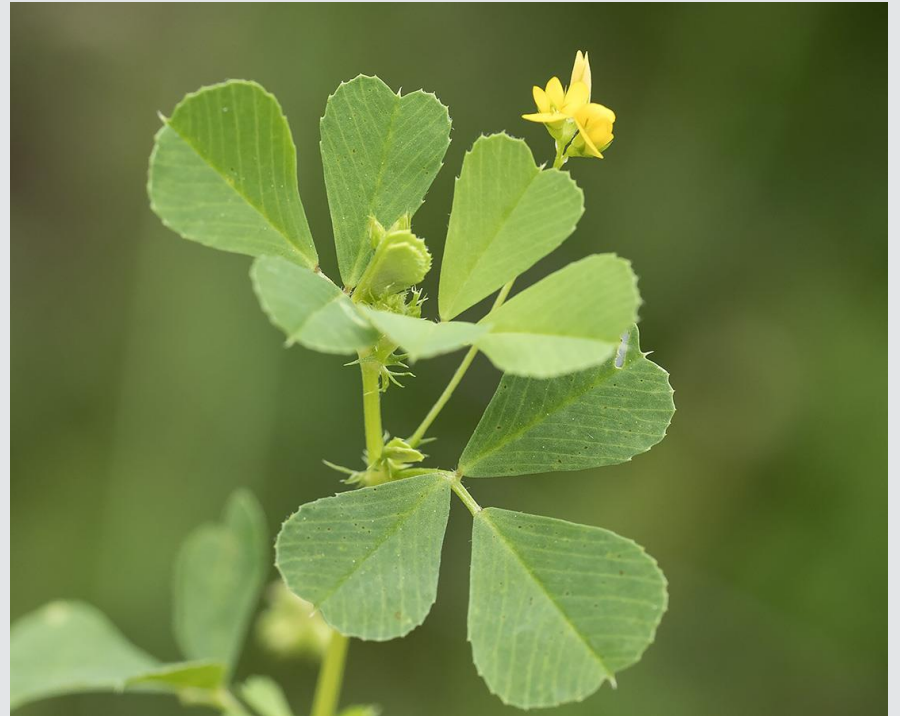

# Barrel medic (*Medicago truncatula*)



**Barrel medic**  
**(*Medicago truncatula*)**  
**leaf**



**Barrel medic**  
**(*Medicago truncatula*)**  
**leaf**

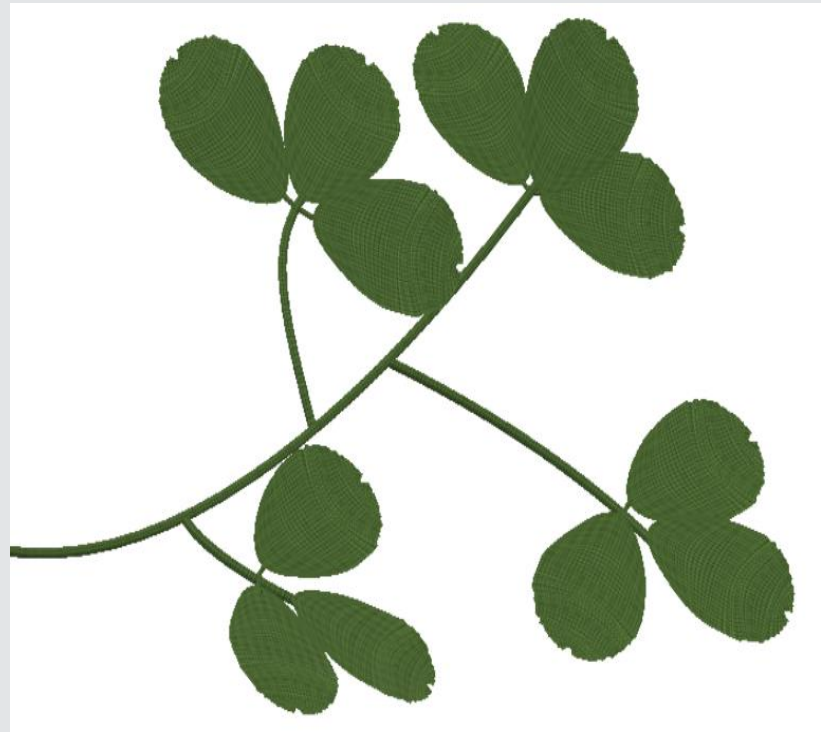

# Barrel medic (*Medicago truncatula*)

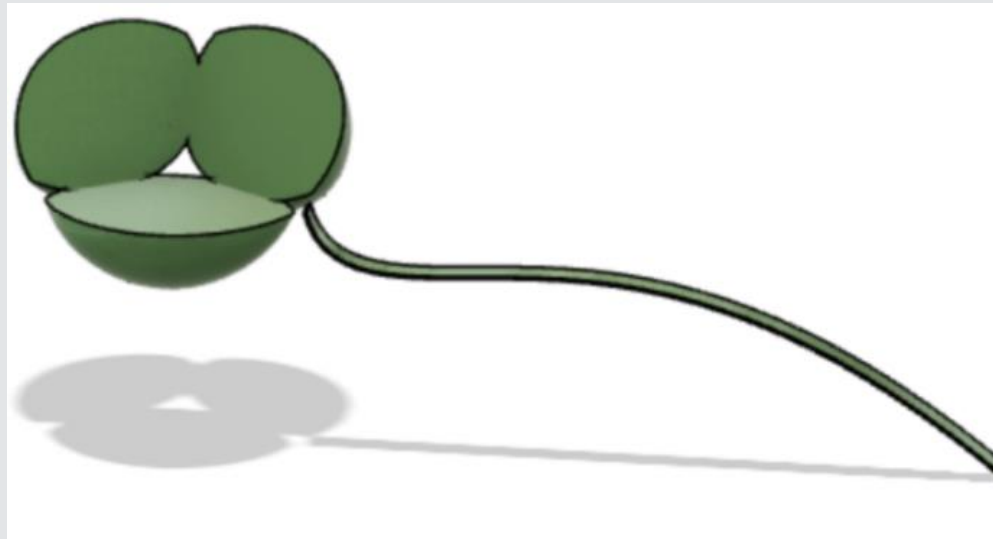

**Common milkweed  
(*Asclepias syriaca*)  
flower**





# Common milkweed (*Asclepias syriaca*) flower

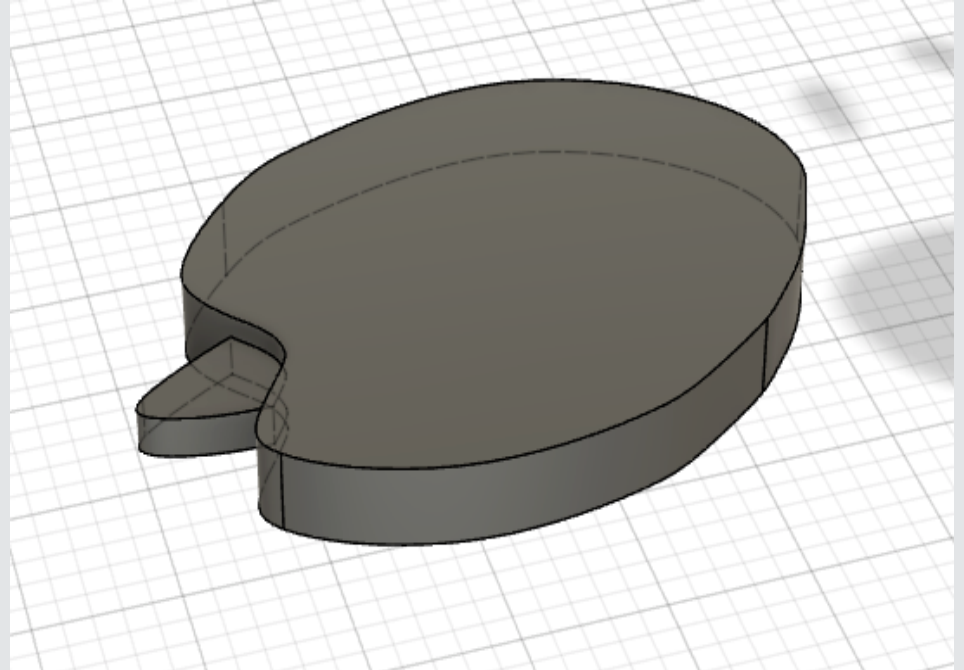

**Common milkweed  
(*Asclepias syriaca*)  
flower**

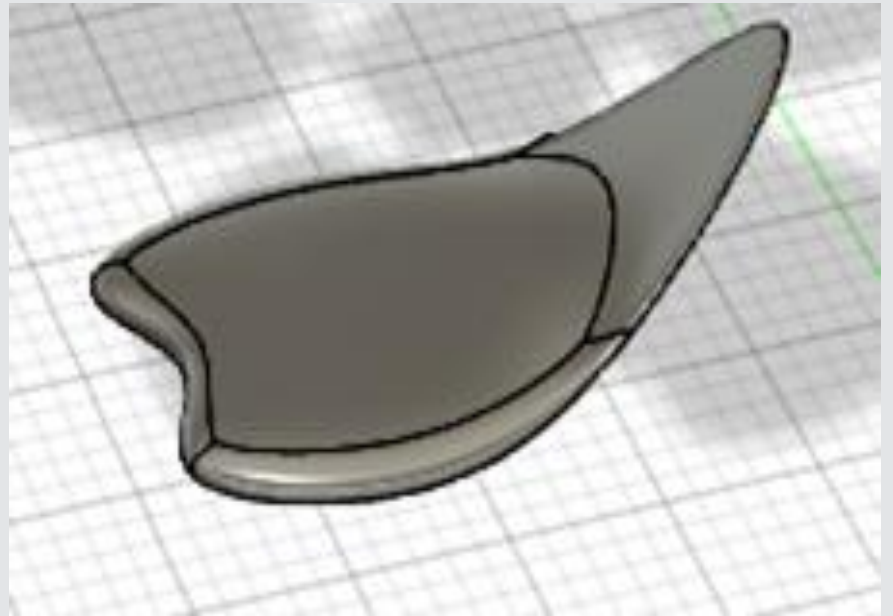

# Common milkweed (*Asclepias syriaca*) flower

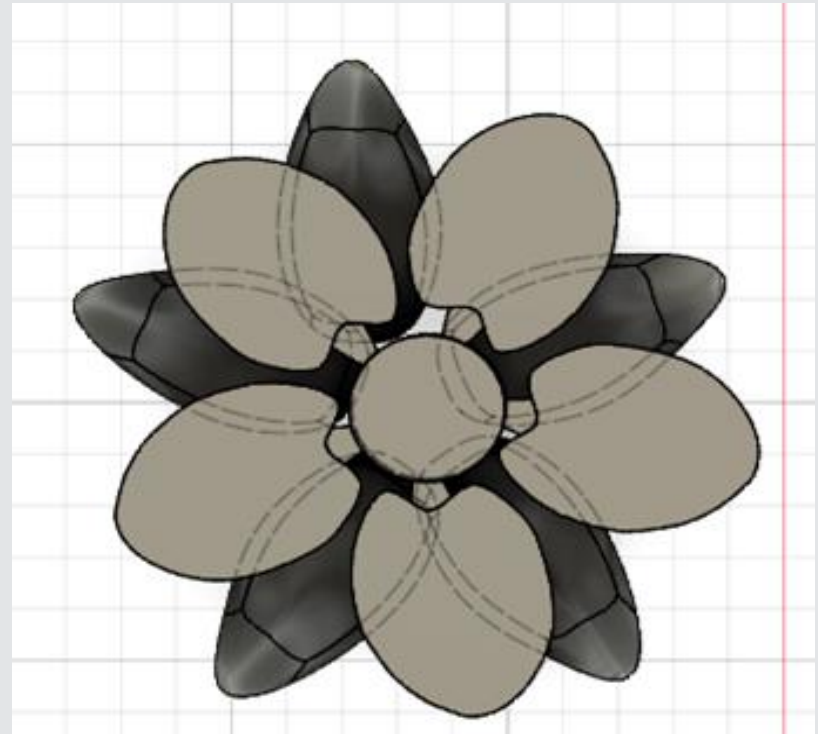

**Common milkweed  
(*Asclepias syriaca*)  
flower**

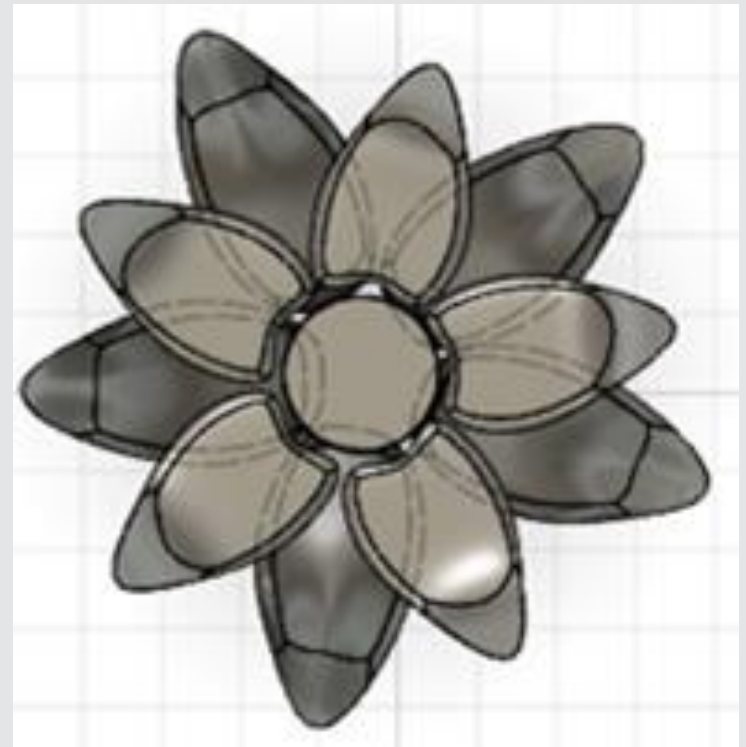

# Common milkweed (*Asclepias syriaca*) flower



**Common milkweed  
(*Asclepias syriaca*)  
stem**



# Common milkweed (*Asclepias syriaca*) stem

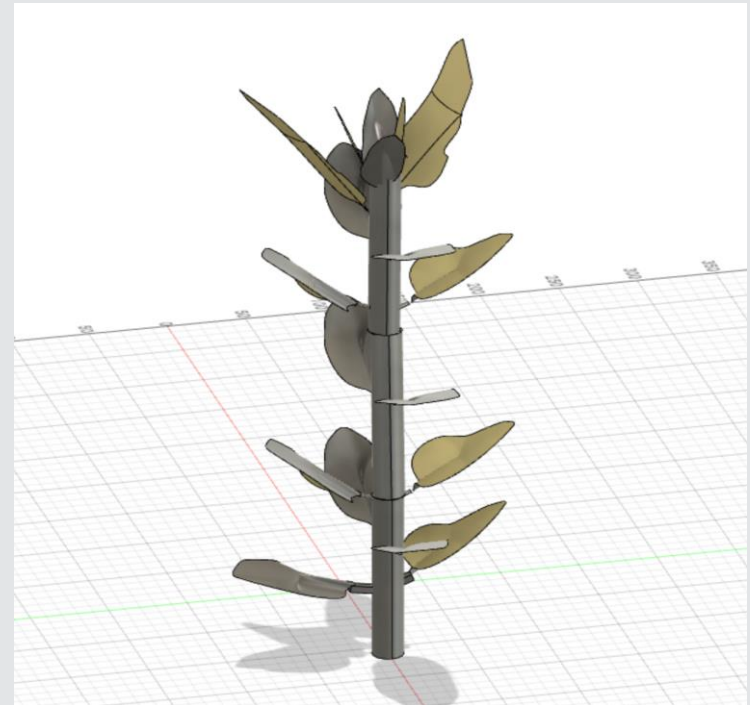

# Common milkweed (*Asclepias syriaca*) stem

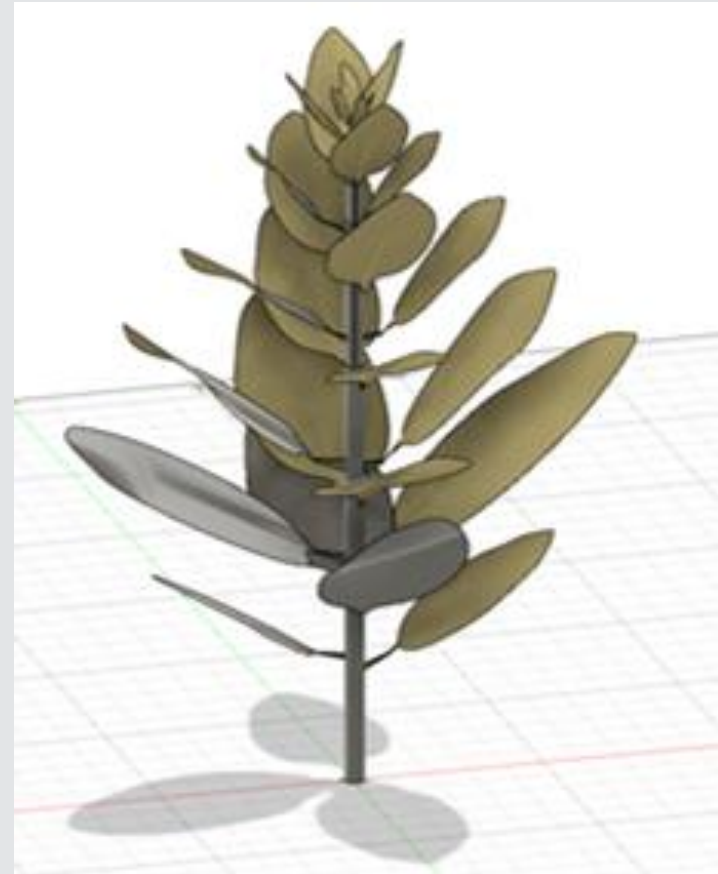



**Common milkweed  
(*Asclepias syriaca*)  
plant**



# Common milkweed (*Asclepias syriaca*) plant



**Chlamydomona**  
**(*Chlamydomonas***  
***reinhardtii*)**  
**cell**



# Chlamydomona (*Chlamydomonas reinhardtii*) cell

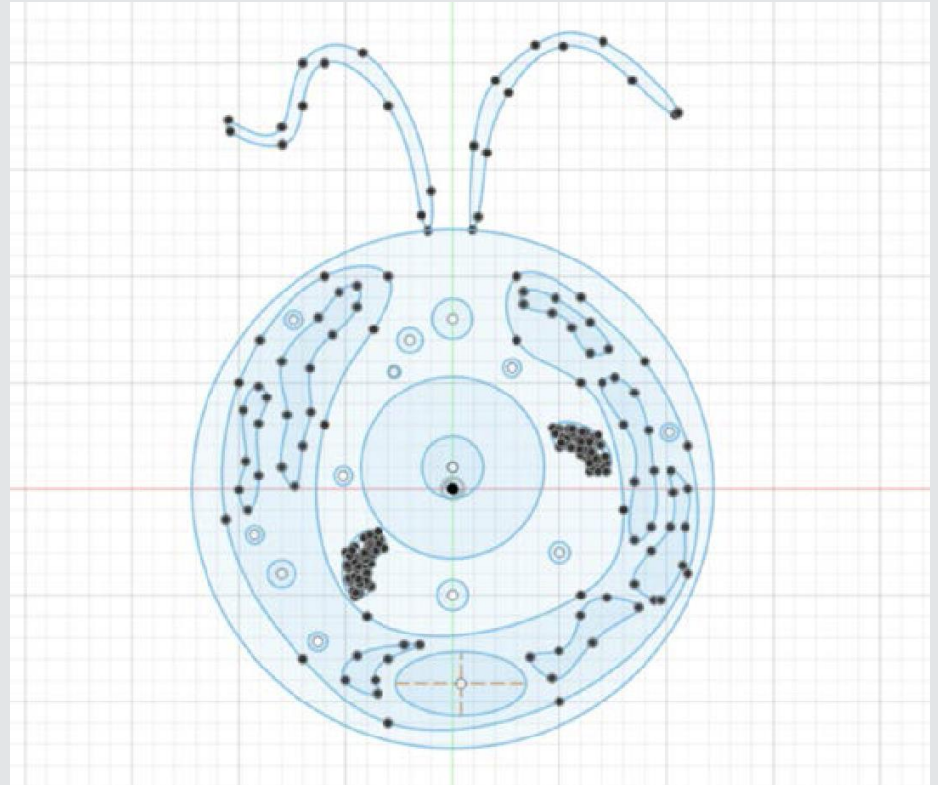

**Chlamydomona**  
**(*Chlamydomonas***  
***reinhardtii*)**  
**cell**



**Chlamydomona  
(*Chlamydomonas  
reinhardtii*)  
cell**



# Chlamydomona (*Chlamydomonas reinhardtii*) cell



# Volvox (*Volvox carteri*) colony

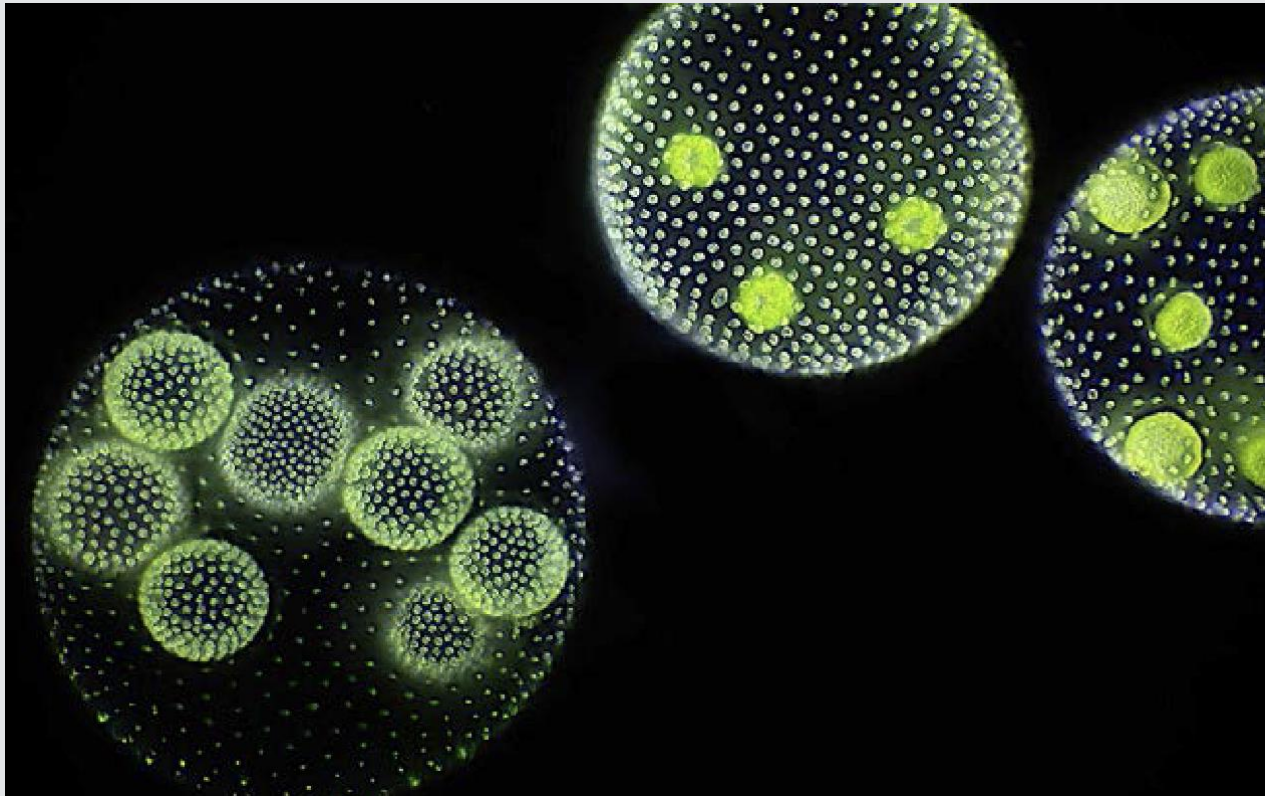



# Volvox (*Volvox carteri*) colony

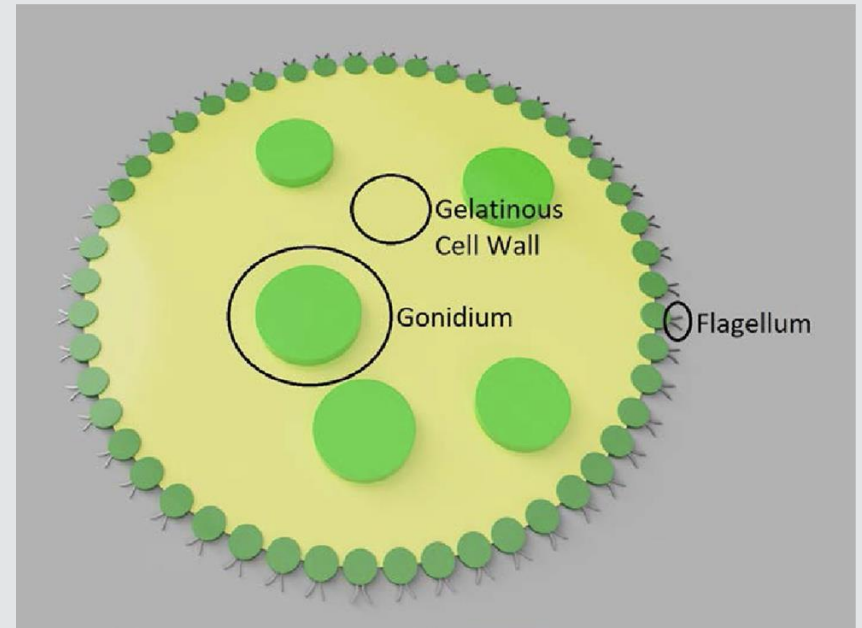

# Volvox (*Volvox carteri*) colony

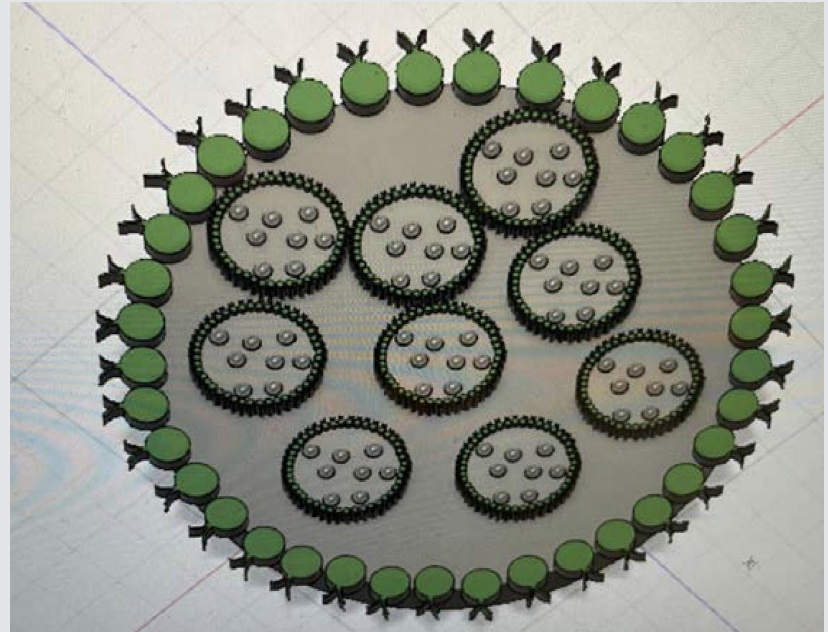

**Indiangrass  
(*Sorghastrum nutans*)  
spiklet**



# Indiangrass (*Sorghastrum nutans*) spiklet



# Indiangrass (*Sorghastrum nutans*) spiklet

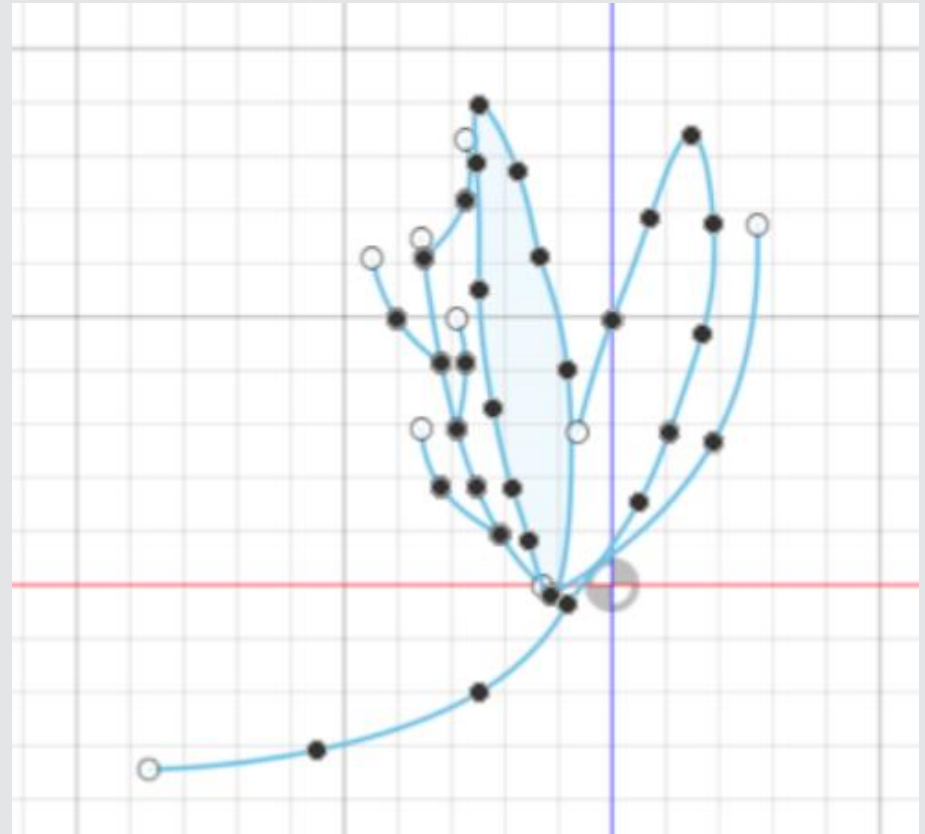

# Indiangrass (*Sorghastrum nutans*) spiklet

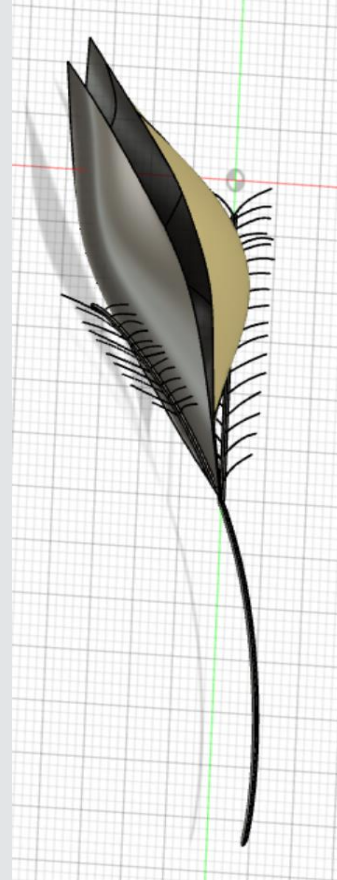

**Indiangrass**  
**(*Sorghastrum nutans*)**  
**spiklet**



# Soybean (*Glycine max*)





# Soybean (*Glycine max*) Pod

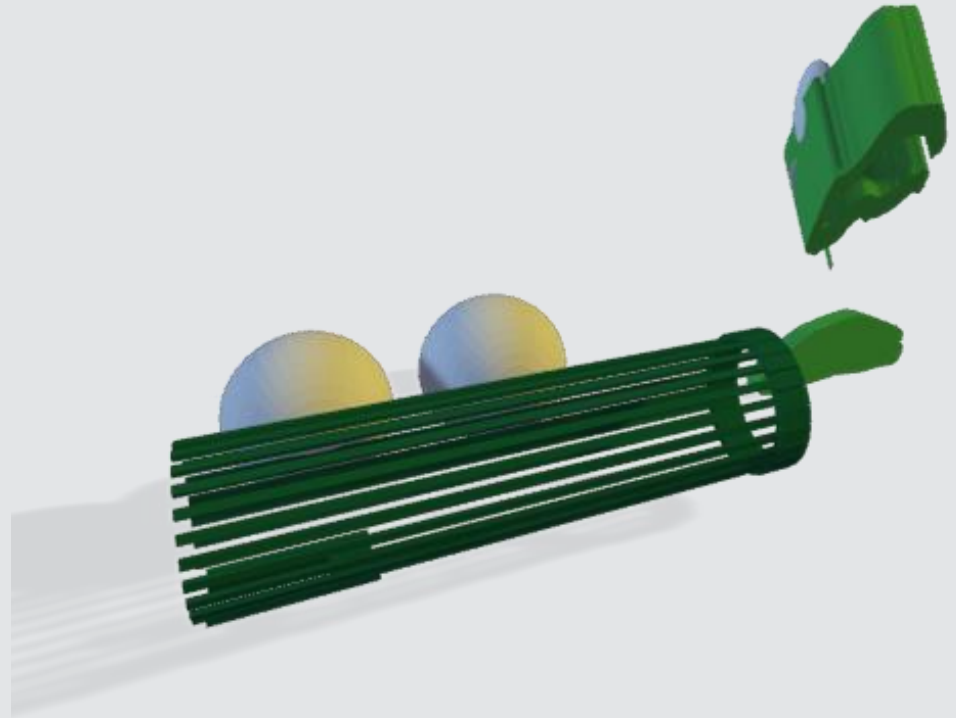



DONALD DANFORTH  
PLANT SCIENCE CENTER

[DANFORTHCENTER.ORG](http://DANFORTHCENTER.ORG)